

# ● Shock Absorbers for Magnet Type Rodless Cylinders MRG

## Specifications

Item	Model	KSHDM 5×6	KSHDM 5×8	KSHDM 5×10	KSHDM 6×10	KSHDM 8×12	KSHDM 10×15	KSHDM 12×18
Applicable cylinder		MRGH6	MRGH10	MRG□16	MRG□20	MRG□25	MRG□32	MRG□40
Maximum absorption	J [ft·lbf]	0.5 [0.37]	1.0 [0.74]	2.5 [1.84]	3.9 [2.88]	5.9 [4.35]	13.3 [9.81]	26.5 [19.55]
Absorbing stroke	mm [in.]	6 [0.24]	8 [0.31]	10 [0.39]	10 [0.39]	12 [0.47]	15 [0.59]	18 [0.71]
Maximum impact speed	mm/s [ft./sec.]	800 [2.6]						
Maximum operating frequency	cycle/min	60						
Spring return force <sup>Note</sup>	N [lbf.]	4.9 [1.10]	7.8 [1.75]	6.9 [1.55]	6.9 [1.55]	19.6 [4.41]	14.7 [3.30]	16.7 [3.75]
Angle variation		2° or less						
Operating temperature range	°C [°F]	0~60 [32~140]						

Note: Values when compressed.

## Order Codes

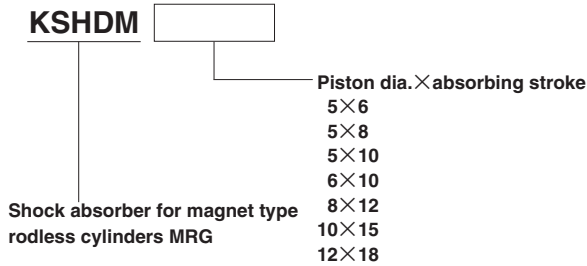

## Dimensions (mm)

Note: The mounting nut is also used for a stopper bolt.

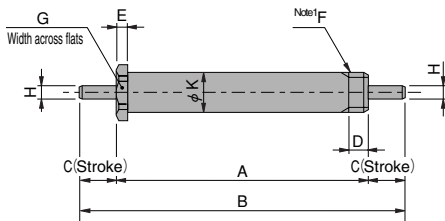

Model	Code	A	B	C	D	F	G	H	K	E
KSHDM5×6		46	58	6	5	M8×1	12	2.5	8 <sup>-0.03</sup> <sub>-0.17</sub>	2.8
KSHDM5×8		51	67	8	5	M10×1	14	3	10 <sup>-0.03</sup> <sub>-0.18</sub>	2.8
KSHDM5×10		66	86	10	5	M10×1	14	3	10 <sup>-0.03</sup> <sub>-0.18</sub>	2.8
KSHDM6×10		73	93	10	7	M12×1	17	3	12 <sup>-0.04</sup> <sub>-0.19</sub>	3.8
KSHDM8×12		80	104	12	8	M14×1.5	19	5	14 <sup>-0.04</sup> <sub>-0.21</sub>	4.8
KSHDM10×15		99	129	15	10	M18×1.5	22	5	18 <sup>-0.05</sup> <sub>-0.22</sub>	6.8
KSHDM12×18		109	145	18	10	M20×1.5	24	5	20 <sup>-0.05</sup> <sub>-0.22</sub>	6.8

Note: The mounting nut is not supplied. Use the mounting nut for MRG's stopper bolt.

**Caution:** For Magnet Type Rodless Cylinders MRG series, see the Actuators General Catalog.